

- Panel Board
- Data Cabinet
- Socket Outlet
- Switch
- Telephone & Data
- Lighting Fixture

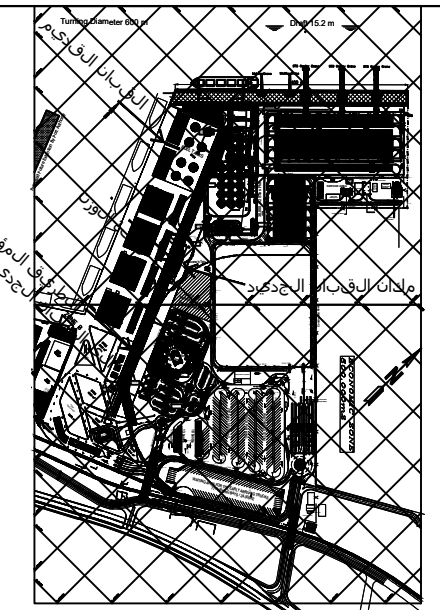

### ELECTRICAL LAYOUT

**Remark:**

The contractor must included in his lump sum price of weigh room, all electrical works as per above drawings, (With joining with existing network, with all related pipes, cables, and manholes, as directed by the Engineer.)

مشروع نقل قبان الفحم  
في حرم مرفأ طرابلس  
الى المنطقة الخلفي  
للمستودع رقم 2

ملاحظات

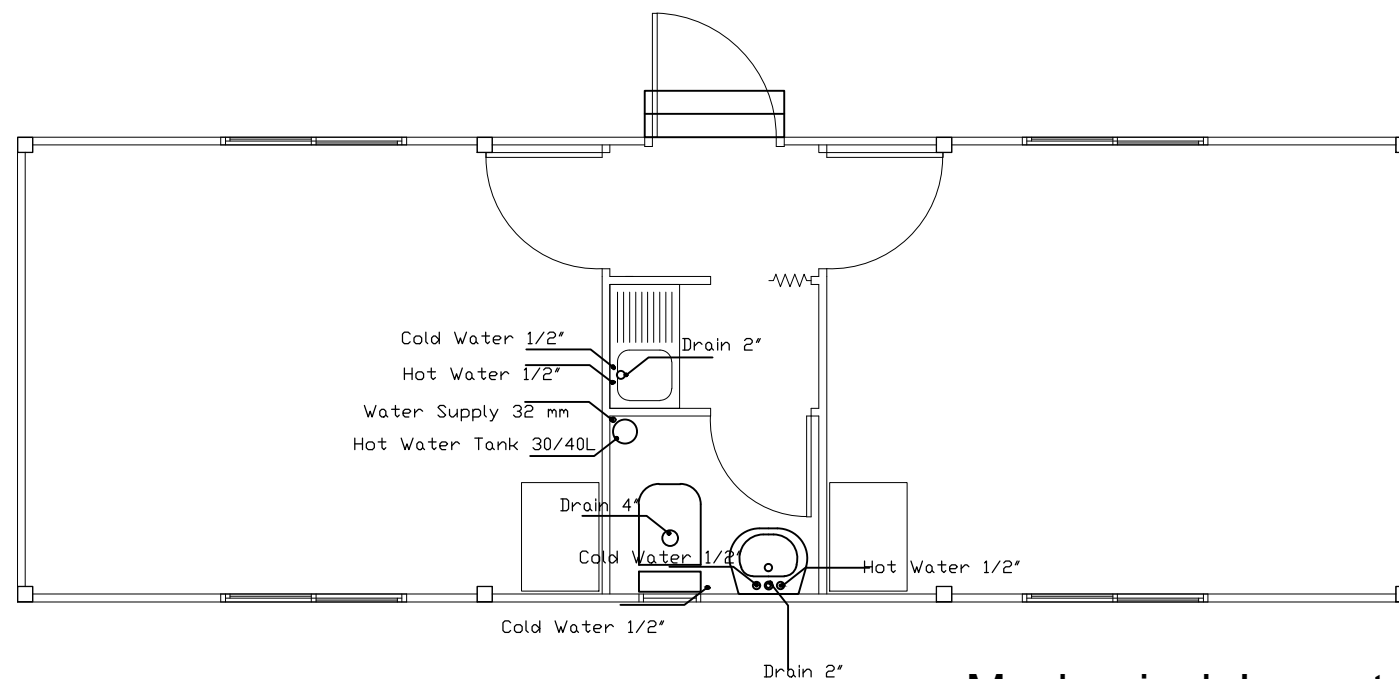

ppr Hot Water Tank 30-40 L

- 9 m 25
- 3 m 32
- 7 Elbows 25x1/2
- 6 Elbows 25mm
- 1 T 32x25x25mm
- 4 Coupling 25mm

pvc

- 2 T y 4"
- 2 Reducer 4"x2"
- 3 Elbows 2"
- 4 Elbows 4"
- 2m 4" pipe
- 6m 2" pipe
- 4 Open Elbows 2"

### Mechanical Layout

**Remark:**

The contractor must included in his lump sum price of weigh room, all mechanical works as per above drawings, (With joining all drains outlets with existing network, with all related pipes and manholes, as directed by the Engineer.)

Project : Prefab. Offices  
Electrical & Mechanical dwgs  
Scale 1/50

لوحة رقم 3  
خريطة غرفة الوزن

إعداد: الدائرة الفنية في  
مرفأ طرابلس